



alan

Bungalow Park, Bradenstoke, SN15

ALAN

01793 840 222 | alanhawkins.co.uk

alan
hawkins
PROPERTY SALES & LETTINGS



- Two Bedroom Twin Park Home
- Private Driveway
- Edge Of Park Position
- Two Reception Rooms

- No Onward Chain
- Generous Plot
- Broken Views Of Dauntsy Vale Beyond
- Bedroom One With Rear Balcony

34 Bungalow Park Bradenstoke, SN15 4EP

£99,995

For sale with no onward chain is this 36 x 20 Omar Colorado two bedroom twin park home pleasantly positioned offering broken distant views across Dauntsy Vale situated on the edge of 'Bungalow Park,' a pet friendly residential site for the over 50's.

Originally sited in 1975, this home benefits a rare private driveway to the side and a generous rear garden to the rear. This home internally offers a triple aspect dining room, living room to the rear with views over the garden and beyond, two bedrooms with bedroom enjoying French doors leading out to a raised rear patio seating area, bathroom

with shower over bath, a good size kitchen and inner hallway leading to a front entrance porch.

Other features include gas (LPG) central heating via a combination boiler, uPVC double glazing, mains water, waste and electric including broadband speeds with an average of 1600 M/bps available via sky.

For more information or to arrange a viewing contact Alan Hawkins Property Sales on 01793 840222



Viewings

By appointment through Alan Hawkins Property Sales. Tel: 01793 840 222

Council Tax: Wiltshire Council

Tax Band A For information on tax banding and rates, please call Wiltshire Council

Management Fee

Monthly Pitch Fee: c£209.46



Energy Efficiency Rating (England & Wales)

Energy Efficiency Rating		Current	Potential
Very energy efficient - lower running costs			
(92 plus) A			
(81-91) B			
(69-80) C			
(55-68) D			
(39-54) E			
(21-38) F			
(1-20) G			
Not energy efficient - higher running costs			
England & Wales		EU Directive 2002/91/EC	

GROUND FLOOR
682 sq.ft. (63.4 sq.m.) approx.

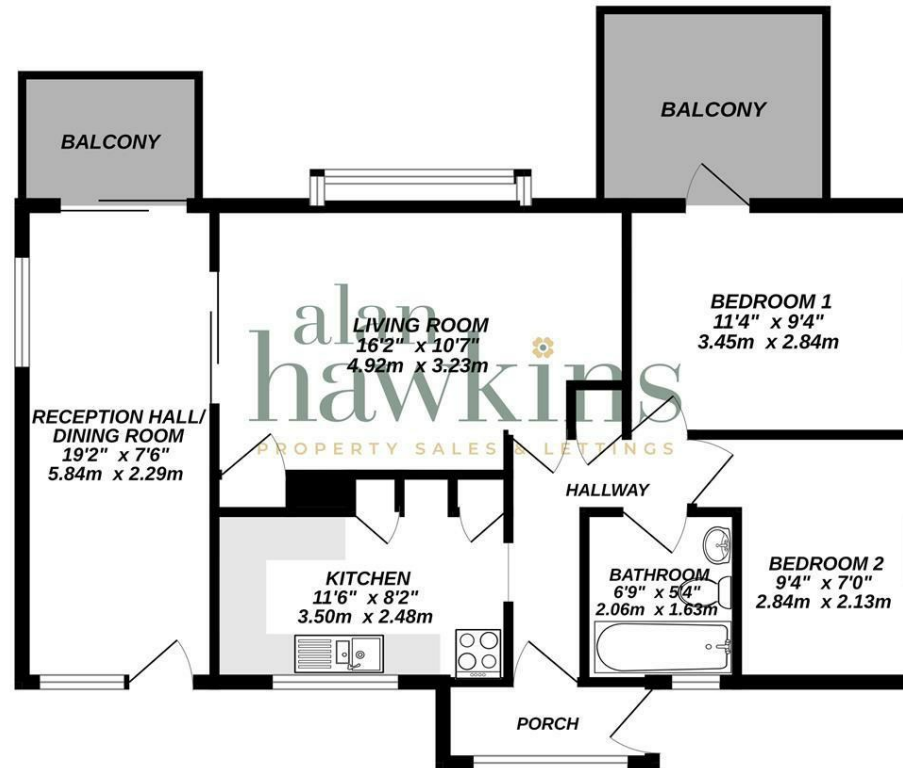

TOTAL FLOOR AREA: 682 sq.ft. (63.4 sq.m.) approx.

Whilst every attempt has been made to ensure the accuracy of the floorplan contained here, measurements of doors, windows, rooms and any other items are approximate and no responsibility is taken for any error, omission or mis-statement. This plan is for illustrative purposes only and should be used as such by any prospective purchaser. The services, systems and appliances shown have not been tested and no guarantee as to their operability or efficiency can be given.
Made with Metropix ©2024